

SPECIFIC PURPOSE (TREE) SURVEY

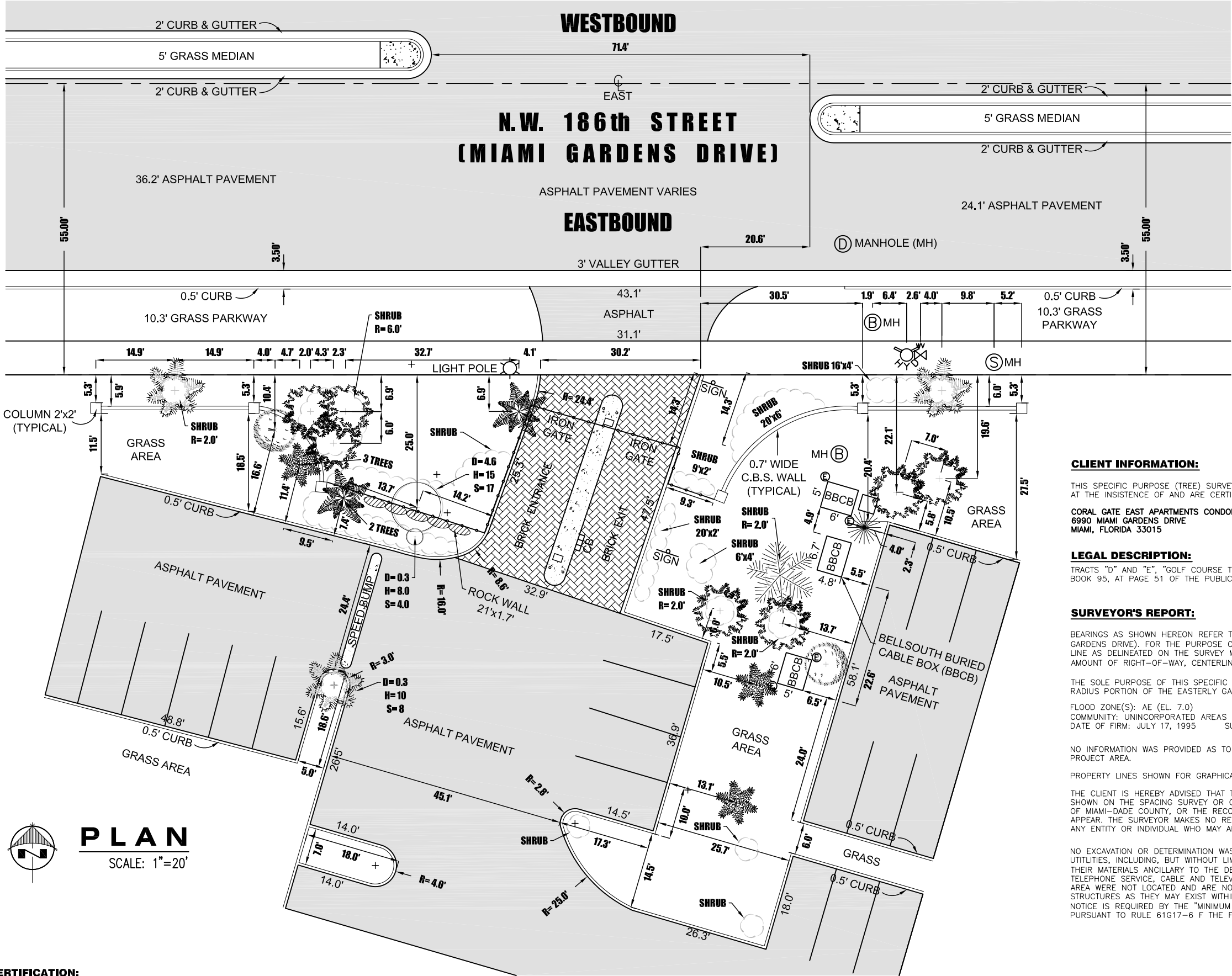

TREE LEGEND

TREE	DEFINITION	DIAMETER (Feet)	HEIGHT (Feet)	SPREAD (Feet)
	Florida Royal Palm.	1.3	35	20
	Guadalupe Palm.	1.0	25	17
	King Alexander Palm.	0.7	35	12
	Mediterranean Fan Palm.	0.6	60	8.5
	Sabal Palmetto Palm.	1.6	15	12
	Flcus Tree.	0.6	4.5	5
	Oak Tree.	0.4	30	20
	Shrub (Different Specimen No Identified).	SEE DESCRIPTION		
	Unknown Tree.	SEE DESCRIPTION		

CLIENT INFORMATION:

THIS SPECIFIC PURPOSE (TREE) SURVEY AND THE SURVEY MAP AND REPORT RESULTING THEREFROM WERE PREPARED AT THE INSISTENCE OF AND ARE CERTIFIED TO:

CORAL GATE EAST APARTMENTS CONDOMINIUM
6990 MIAMI GARDENS DRIVE
MIAMI, FLORIDA 33015

LEGAL DESCRIPTION:

TRACTS "D" AND "E", "GOLF COURSE TOWERS SUBDIVISION", ACCORDING TO THE PLAT THEREOF, AS RECORDED IN PLAT BOOK 95, AT PAGE 51 OF THE PUBLIC RECORDS OF MIAMI-DADE COUNTY, FLORIDA.

SURVEYOR'S REPORT:

BEARINGS AS SHOWN HEREON REFER TO A ASSUMED BEARING OF EAST, ALONG THE SURVEY N.W. 186th STREET (MIAMI GARDENS DRIVE). FOR THE PURPOSE OF THIS SURVEY, THIS MAY BE CONSIDERED A WELL-MONUMENTED AND IDENTIFIED LINE AS DELINEATED ON THE SURVEY MAP. THE BASELINE OF SURVEY WAS CREATED BY RECOVERY OF A SUFFICIENT AMOUNT OF RIGHT-OF-WAY, CENTERLINE AND/OR MONUMENT CONTROL LINE.

THE SOLE PURPOSE OF THIS SPECIFIC PURPOSE (TREE) SURVEY IS TO SHOW THE TREE LOCATION OF A 50 FOOT RADIUS PORTION OF THE EASTERLY GATE ENTRANCE OF THE PROPERTY AS DESCRIBED IN THE LEGAL DESCRIPTION.

FLOOD ZONE(S): AE (EL. 7.0)
COMMUNITY: UNINCORPORATED AREAS (120635)
DATE OF FIRM: JULY 17, 1995 SUFFIX: J PANEL: 075

NO INFORMATION WAS PROVIDED AS TO THE EXISTENCE OF ANY EASEMENTS OR OPERATING RESTRICTIONS WITHIN THE PROJECT AREA.

PROPERTY LINES SHOWN FOR GRAPHICAL PURPOSES. NO BOUNDARY WAS PERFORMED.

THE CLIENT IS HEREBY ADVISED THAT THERE MAY BE LEGAL RESTRICTIONS ON THE PROJECT AREA THAT ARE NOT SHOWN ON THE SPACING SURVEY OR CONTAINED WITHIN THIS REPORT THAT MAY BE FOUND IN THE PUBLIC RECORDS OF MIAMI-DADE COUNTY, OR THE RECORDS OF ANY OTHER PUBLIC AND PRIVATE ENTITIES AS THEIR JURISDICTIONS MAY APPEAR. THE SURVEYOR MAKES NO REPRESENTATION AS TO OWNERSHIP OR POSSESSION OF THE PROJECT AREA BY ANY ENTITY OR INDIVIDUAL WHO MAY APPEAR OF PUBLIC RECORD.

NO EXCAVATION OR DETERMINATION WAS MADE AS TO HOW THE PROJECT AREA IS SERVED BY UTILITIES. SUBSURFACE UTILITIES, INCLUDING, BUT WITHOUT LIMITATION TO PIPES, WIRES, VAULTS, BOXES, DRAIN TILES, VOIDS, CABLES AND THEIR MATERIALS ANCILLARY TO THE DELIVERY AND/OR DISPOSAL OF WATER, WASTEWATER, SEWAGE, ELECTRICITY, GAS, TELEPHONE SERVICE, CABLE AND TELEVISION. AS THEY MAY EXIST WITHIN, UPON, ACROSS OR ABUTTING THE PROJECT AREA WERE NOT LOCATED AND ARE NOT SHOWN. IN ADDITION, THE FOUNDATIONS OF THE EXISTING SURFACE STRUCTURES AS THEY MAY EXIST WITHIN, UPON, ACROSS OR ABUTTING THE PROJECT AREA WERE NOT LOCATED. THIS NOTICE IS REQUIRED BY THE "MINIMUM TECHNICAL STANDARDS FOR LAND SURVEYING IN THE STATE OF FLORIDA," PURSUANT TO RULE 61G17-6 F THE FLORIDA ADMISTRATIVE CODE.

PLAN
SCALE: 1"=20'

CERTIFICATION:

I HEREBY CERTIFY: THAT THIS SPECIFIC PURPOSE (TREE) SURVEY WAS PREPARED UNDER MY DIRECT SUPERVISION AND THAT IT IS TRUE AND CORRECT TO THE BEST OF MY KNOWLEDGE AND BELIEF AND FURTHER, THAT SAID "SPECIFIC PURPOSE (TREE) SURVEY" MEETS THE INTENT OF THE "MINIMUM TECHNICAL STANDARDS FOR LAND SURVEYING IN THE STATE OF FLORIDA", PURSUANT TO RULE 61G17-6 OF THE FLORIDA ADMINISTRATIVE CODE AND ITS IMPLEMENTING RULE, CHAPTER 472.027 OF THE FLORIDA STATUTES.

NOT VALID WITHOUT THE SIGNATURE AND THE ORIGINAL RAISED SEAL OF A FLORIDA LICENSED SURVEYOR AND MAPPER. ADDITIONS OR DELETIONS TO SURVEY MAPS OR REPORTS BY OTHER THAN THE SIGNING PARTY OR PARTIES IS PROHIBITED WITHOUT WRITTEN CONSENT OF THE SIGNING PARTY OR PARTIES.

ROBERTO R. BRIZUELA, P.S.M.
PROFESSIONAL SURVEYOR AND MAPPER
No. 3064 STATE OF FLORIDA

ROBERTO R. BRIZUELA & ASSOCIATES

7319 WEST FLAGLER STREET, MIAMI, FL. 33144
PHONE: (305) 551-4393 - FAX: (305) 266-6112

Date:

05/07/08

Job No.:

0805-0001